

PLEASE DO NOT SCALE, ASK IF IN DOUBT

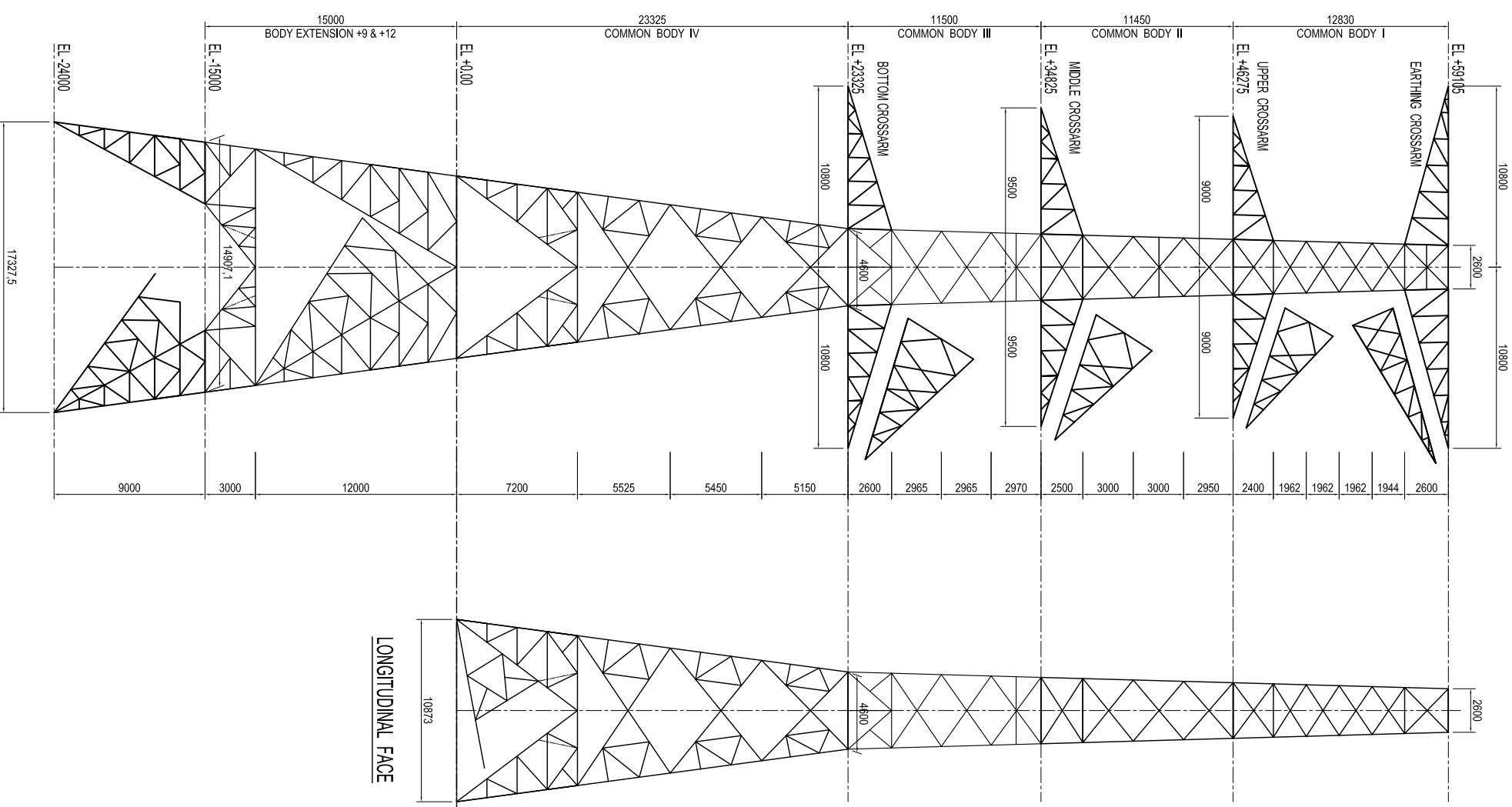

IMPORTANT NOTES

1. ALL DIMENSIONS ARE IN MILLIMETERS UNO.
2. ALL MEMBERS WITH 'H' LETTER ARE OF HIGH YIELD STEEL (HYS) TO BE TO JIS G3101 GRADE SSS40.
3. ALL MEMBERS WITHOUT 'H' LETTER ARE OF MILD STEEL (MS) TO BE TO JIS G3101 GRADE SS400.
4. ALL ANGLE SECTIONS TO BE JIS G3192.
5. ALL BOLTS TO BE GRADE 8.8, NUTS TO BE GRADE 8 TO JIS B1181 OR EQUIVALENT.
6. BOLTS TO BE TO JIS B1051 (OR EQUIVALENT) WITH A THREAD LENGTH EQUAL TO 2 x DIAMETER + 6MM AND COMPLETE WITH 1 NOS OF SPIRAL WASHER AND STANDARD NUT TO BE JIS B1181 OR EQUIVALENT.
7. SPIRAL WASHERS TO BE TO JIS B1251 GRADE NO.2 OR EQUIVALENT.
8. ALL STEEL WORK TO BE HOT-DIP GALVANIZED IN ACCORDANCE WITH ISO 1461 AFTER FABRICATION.
9. ALL BOLTS TO BE SPUN GALVANIZED IN ACCORDANCE WITH BS 729 OR ISO 1461.
10. GUNTING STEEL CONSTRUCTION CLAIMS NO RESPONSIBILITY DUE TO STRENGTH OF DESIGN & DETAIL.
11. ALL SECTIONS, PROFILES, DIMENSION & CONNECTION DETAIL MUST BE VERIFIED BY THE CUSTOMER.

THIS DRAWING IS THE PROPERTY OF PT. GUNUNG STEEL CONSTRUCTION, DO NOT HAND OVER TO ANY OTHER THIRD PARTY WITHOUT WRITTEN PERMISSION ESC. FM. EG. 07 (Sheet 3 of 4)

REFER CONTRACT NO. :-

APPROVED BY

NAME : _____

SIGNATURE : _____

DATE : _____

REV.	DATE	DESCRIPTION	BY	CHK'D	DSN'D
0	28/02/18	ISSUED FOR APPROVAL	DY		

Client : PT. PLN (PERSERO)

Head Office :
 No. Tropic Re. 001/006/L, Salsabina
 DUKUNG BEKASI, BOJONG JAYA 16061-INDONESIA
 Telp : (021) 880789-93 801021801
 Fax : (021) 88078157 86308283
 URL : <http://www.gunungsteel.com>
 e-mail : cs@gunungsteel.com

Project Title : TOWER TRANSMISI

Head Office :
 GSC CONTRACT NO. : 36/GSC-EFC/CP/ED/70/JKT/16
 PLN CONTRACT NO. : 1420.PJ/DAN.02.03/DIR/2016

Drawing Title : OUTLINE TOWER 500 KV
 4XZEBRA TYPE BB-3 S/D BB+15
 (T7.B2-03,48,33,H S/D T7.B2.+15,48,33,H)

Drawn By : -
 Design By : -
 Date : -

Checked By : -
 Date : -

Drawing No. : 36-150KV-B-A01A

SCALE
 NTS
 REV.